



WASHINGTON STATE BOUNDARY REVIEW BOARD FOR YAKIMA COUNTY

128 North Second Street
Fourth Floor Courthouse
Yakima, Washington 98901

(509) 574-2300 • FAX (509) 574-2301

Date: September 19, 2022

TO: Boundary Review Board Members, Corporate Counsel, City of Grandview, Board of County Commissioners, Assessor, Treasurer, Elections Division, Sheriff's Office, Public Services (Director, Planning, Building & Fire Safety, Code Enforcement, Environmental Services, Water Resources, GIS), County Roads, Parks and Trails, Fire District #5, Sunnyside Valley Irrigation District, Yakima Valley Libraries, Yakima Valley Conference of Governments, South Yakima Conservation District, Bureau of Indian Affairs, Yakama Nation, WSDOT South Central Region

FROM: Aman Walia
Chief Clerk - Boundary Review Board

SUBJ: **File No.: BRB2022-00003, City of Grandview – Statewide Development Annexation**

Enclosed is the City of Grandview's Ordinance 2022-12, which annexes the subject area. The Ordinance was recorded under Auditors File # 8155251 on August 26, 2022, and states that the annexation shall be effective August 29, 2022.

If you have any questions or need any further information, please contact me at aman.walia@co.yakima.wa.us or 509-574-2300.

Enclosure: City of Grandview Ordinance No. 2022-12
Map outlining area annexed

Yakima County ensures full compliance with Title VI of the Civil Rights Act of 1964 by prohibiting discrimination against any person on the basis of race, color, national origin, or sex in the provision of benefits and services resulting from its federally assisted programs and activities. For questions regarding Yakima County's Title VI Program, you may contact the Title VI Coordinator at 509-574-2300.

If this letter pertains to a meeting and you need special accommodations, please call us at 509-574-2300 by 10:00 a.m. three days prior to the meeting. For TDD users, please use the State's toll free relay service 1-800-833-6388 and ask the operator to dial 509-574-2300.



Return Address:
City of Grandview
Attn: City Clerk
207 West Second Street
Grandview, WA 98930

RECEIVED
SEP 14 2022
CITY OF GRANDVIEW

FILE# 8155251
YAKIMA COUNTY, WA
08/26/2022 12:04:10PM
ORDINANCE
PAGES: 6
CITY OF GRANDVIEW

Recording Fee: 208.50

Document 1 Title: Statewide Development Annexation Ordinance

Reference #'s: _____

Additional reference #'s on page _____

Grantors:
City of Grandview
207 West Second Street, Grandview, WA 98930

Grantees:
Public

Additional grantors on page _____

Additional grantees on page _____

Document 2 Title: _____

Reference #'s: _____

Additional reference #'s on page _____

Grantors:

Grantees:

Additional grantors on page _____

Additional grantees on page _____

Legal Description (abbreviated form: i.e. lot, block, plat or S,T,R quarter/quarter):
That portion of the NW Quarter of the NE Quarter of Section 24 and the SW Quarter of the SE Quarter of Section 13,
all in Township 9 North, Range 23 East W.M.

Additional legal is on page 4

Assessor's Property Tax Parcel/Account Number:

230924-12004 & 230924-12008

Emergency nonstandard document recording: I am requesting an emergency nonstandard recording for an additional fee as provided in RCW 36.18.010. I understand that the recording processing requirements may cover up or otherwise obscure some part of the text of the original document.

Signature: _____

The Auditor/Recorder will rely on the information provided on the form. The staff will not read the document to verify the accuracy or completeness of the indexing information provided herein.

ORDINANCE NO. 2022-12

AN ORDINANCE OF THE CITY OF GRANDVIEW, WASHINGTON, PROVIDING FOR THE ANNEXATION OF PROPERTY KNOWN AS THE STATEWIDE DEVELOPMENT ANNEXATION TO THE CITY OF GRANDVIEW PURSUANT TO THE PETITION METHOD, AND INCORPORATING THE SAME WITHIN THE CORPORATE LIMITS THEREOF, PROVIDING FOR THE ASSUMPTION OF EXISTING INDEBTEDNESS, REQUIRING SAID PROPERTY TO BE ASSESSED AND TAXED AT THE SAME RATE AND BASIS AS OTHER PROPERTY WITHIN SAID CITY, ADOPTING A COMPREHENSIVE LAND USE PLAN, AND CHANGING THE OFFICIAL ZONING MAP OF THE CITY

WHEREAS, the City of Grandview, Washington received a petition for annexation, known as the Statewide Development Annexation, of certain real property pursuant to RCW 35A.14.120, a legal description of which is attached hereto on Exhibit "A"; and

WHEREAS, that said petition set forth the fact that the City Council of the City of Grandview required the assumption of City indebtedness by the area requesting to be annexed; and

WHEREAS, prior to filing of said petition, the City Council had indicated a tentative approval of said annexation; and

WHEREAS, petitioners further understood the proposed zoning of said area proposed for annexation would be C-2 General Business for Parcel Nos. 230924-12004 and 230924-12008; and

WHEREAS, notices of hearing before the Hearing Examiner and the City Council were published in the manner as provided by law; and

WHEREAS, all property within the territory so annexed shall be subject to and is a part of the Comprehensive Plan of the City of Grandview as presently adopted or as is hereafter amended; and

WHEREAS, the Council of the City of Grandview has determined that the best interests and general welfare of the City would be served by the annexation; and

WHEREAS, prior to the City Council taking final action, the City Clerk submitted a "Notice of Intention" to the Yakima County Boundary Review Board pursuant to RCW 36.93.090; and

WHEREAS, on August 12, 2022, the Yakima Boundary Review Board notified the City that the 45-day review period lapsed on the "Notice of Intention" and the annexation was deemed approved by the Boundary Review Board,

NOW THEREFORE, THE CITY COUNCIL OF THE CITY OF GRANDVIEW DO ORDAIN, as follows:

SECTION 1. There has been filed with the City Council of the City of Grandview, a petition in writing signed by property owners owning a majority of the assessed value of the property proposed for annexation hereinafter described on Exhibit "A"; that said petition set forth the fact that the City Council of the City of Grandview required the assumption of City indebtedness by the area requesting to be annexed; that prior to filing of said petition, the City Council had on March 8, 2022 agreed to consider the annexation as proposed in the Letter of Intent; and that petitioners further understood the proposed zoning of said area proposed for annexation would be C-2 General Business for Parcel Nos. 230924-12004 and 230924-12008.

SECTION 2. April 27, 2022 was set as the date for the open record public hearing before the Hearing Examiner and June 14, 2022 was set as the date for the closed record public hearing on said petition before the Grandview City Council; notice of such hearings were published in the Grandview Herald, a newspaper of general circulation in the City of Grandview; notice of such hearings was also posted in three public places within the territory proposed for annexation; notice of such hearings was also mailed to owners of property within three hundred feet of the territory proposed for annexation; and said notice specified the time and place of such hearings and invited interested persons to appear and voice approval or disapproval of the annexation.

SECTION 3. The territory proposed by said petition to be annexed to the City of Grandview is situated in the County of Yakima in the State of Washington, is contiguous, approximate and adjacent to the present corporate limits of said City, and is more particularly described in Exhibit "A," which is attached hereto and incorporated in full by this reference.

SECTION 4. The territory set forth in this ordinance and for which said petition for annexation as filed should be and is hereby made a part of the City of Grandview.

SECTION 5. Pursuant to the terms of the annexation petition, all property within this territory annexed hereby shall be assessed and taxed at the same rate and on the same basis as property within the City, including assessment or taxes in payment of any bonds issued or debts contracted prior to or existing at the date of annexation.

SECTION 6. All property within the territory so annexed shall be subject to and a part of the Comprehensive Plan of the City of Grandview as presently adopted or as is hereafter amended.

SECTION 7. All property within the territory so annexed shall be and hereby is zoned C-2 General Business for Parcel Nos. 230924-12004 and 230924-12008.

SECTION 8. This ordinance shall take effect and be in full force five (5) days after its passage and publication as provided by law.

PASSED by the **CITY COUNCIL** and **APPROVED** by the **MAYOR** at its regular meeting on August 23, 2022.

MAYOR

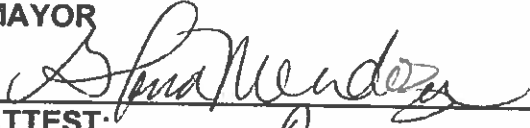
A handwritten signature in black ink, appearing to read "S. Mendez", written over a horizontal line.

ATTEST:

A handwritten signature in black ink, appearing to read "A. O. Harris", written over a horizontal line.

CITY CLERK

APPROVED AS TO FORM:

A handwritten signature in blue ink, appearing to read "D. P. [unclear]", written over a horizontal line.

CITY ATTORNEY

PUBLICATION: 08/24/22

EFFECTIVE: 08/29/22

March 9, 2022

Exhibit "A"

HLA Project No. 22007

Legal Description for Statewide Development Annexation

LEGAL DESCRIPTION

That portion of the Northwest Quarter of the Northeast Quarter of Section 24 and the Southwest Quarter of the Southeast Quarter of Section 13, all in Township 9 North, Range 23 East, W.M. described as follows:

Beginning at the Northwest Corner of said Northeast Quarter of Section 24;
Thence Southerly along the West line of said subdivision to the existing Northerly line of the City Limits established by City of Grandview Ordinance 2008-11, and recorded under Auditor's file number 7612985, records of Yakima County, Washington;
Thence Northeasterly along said existing northerly line of the City limits 139 feet, more or less, to the Southerly right of way line of State Route 1-82;
Thence Southeasterly along said right of way line to the intersection with of the East line of the West 1007.2 feet of said Northwest Quarter of the Northeast Quarter,
Thence Northerly along said line and its Northerly extension to the North right of way line of Olmstead Road;
Thence Westerly along said North right of way line, parallel with the North line of said Section 24 to the Northerly extension of the West line of said Northeast Quarter of Section 24;
Thence South to the Point of Beginning.

Situate in Yakima County, Washington.



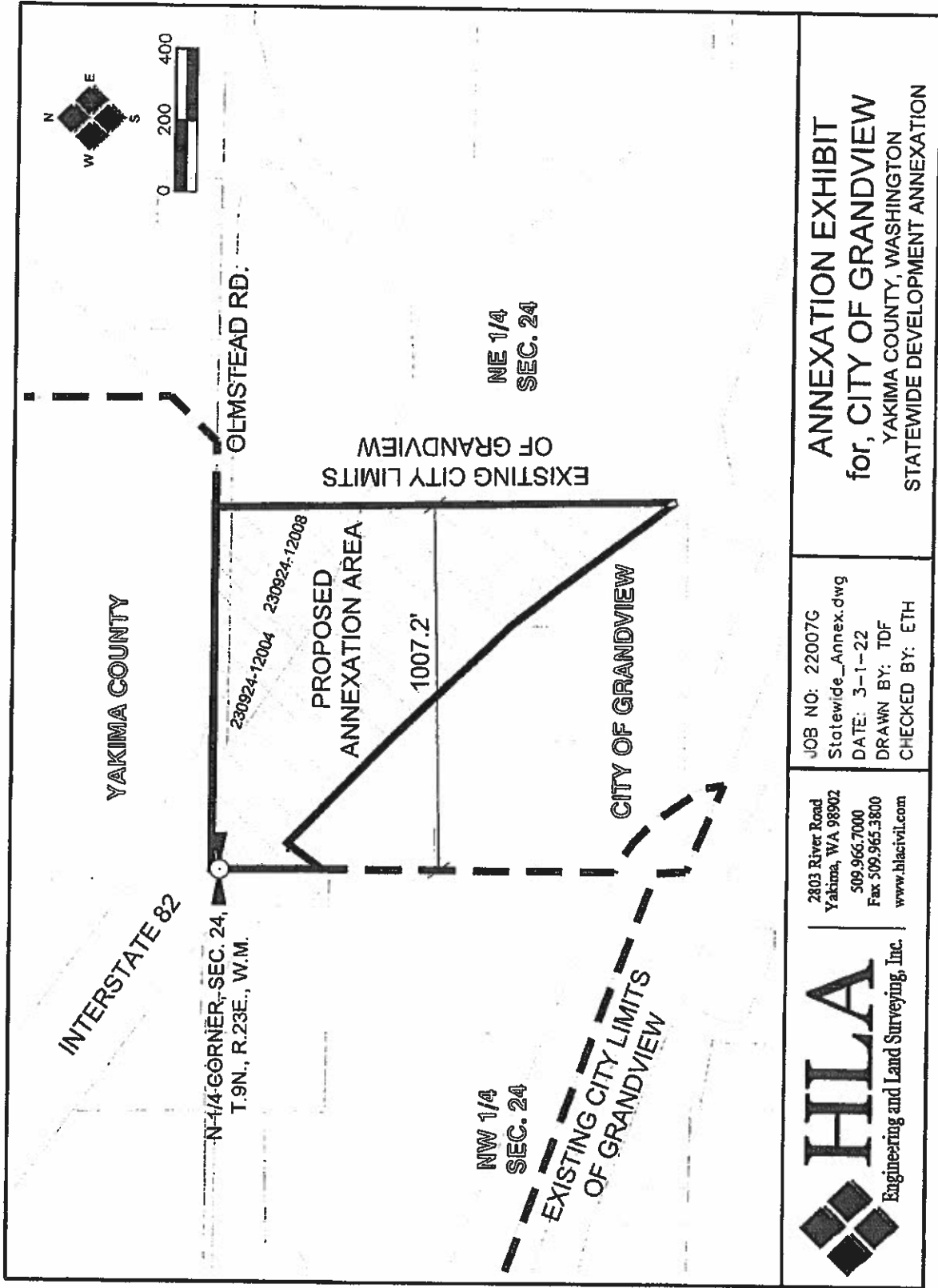

ANNEXATION EXHIBIT
for, CITY OF GRANDVIEW
YAKIMA COUNTY, WASHINGTON
STATEWIDE DEVELOPMENT ANNEXATION

JOB NO: 22007G
Statewide_Annex.dwg
DATE: 3-1-22
DRAWN BY: TDF
CHECKED BY: ETH

2803 River Road
Yakima, WA 98902
509.966.7000
Fax 509.965.3800
www.hla civil.com

HLA
Engineering and Land Surveying, Inc.